



VIEW OF PROPOSED DEVELOPMENT

REVISIONS	
DATE	REV. NO.
6.21.10	Prelim Submittal

VAN RYN ARCHITECTS
LIVABLE WITH IMAGINATION

PROJECT TITLE:
 VICTORIAN VILLAGE
 PROPOSED SKILLED NURSING
 FACILITIES
 HOMER GLEN, IL.

DRAWING NAME:
 PROPOSED DEVELOPMENT OVERALL VIEW

FILE:
DRAWN BY:
SHEET NO.

EX-3

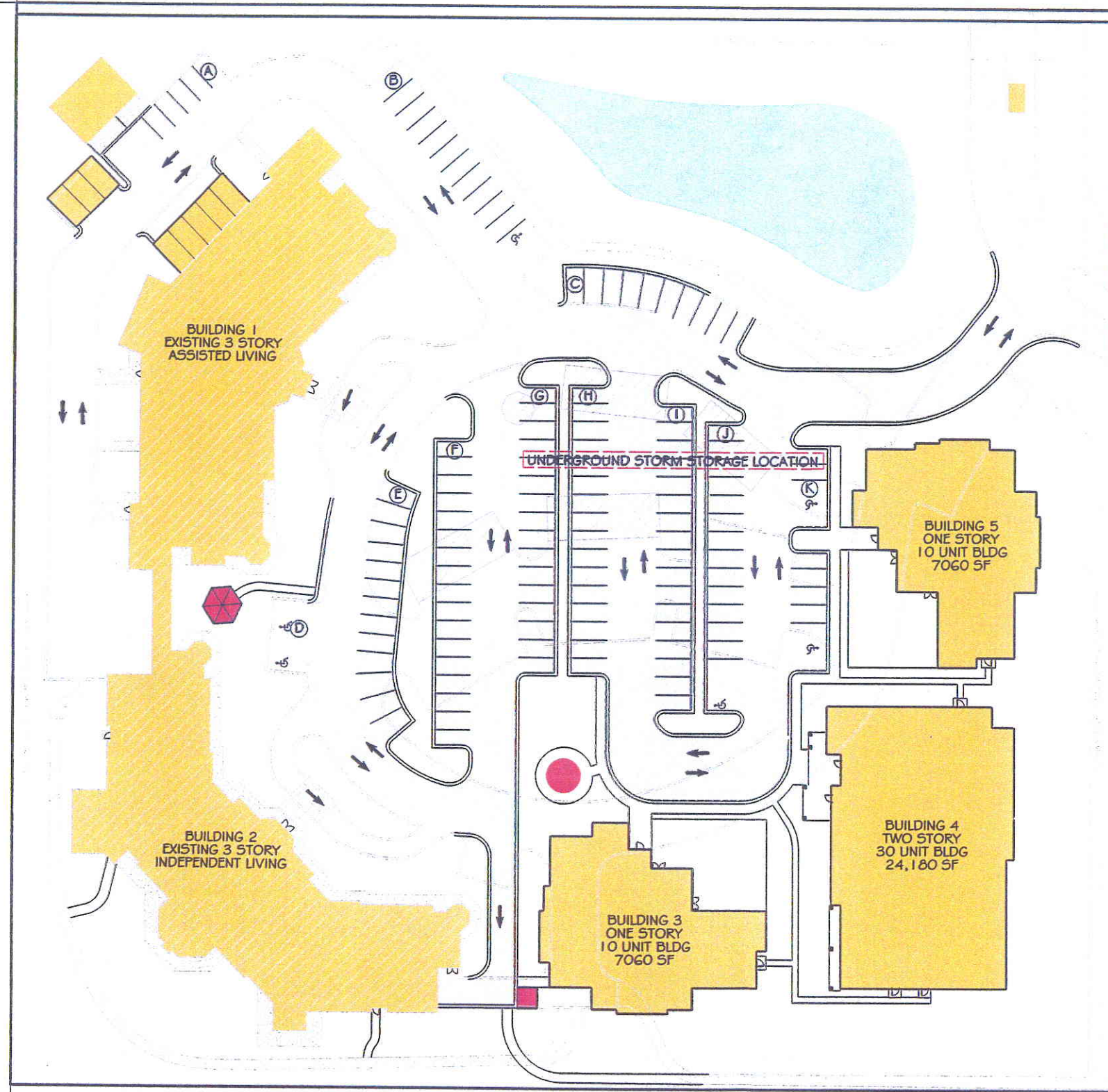
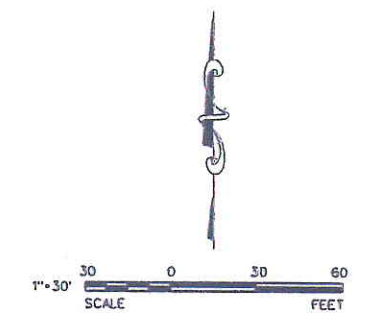

LEGEND	
	BUILDINGS = 59901 SF
	PAVEMENT = 77963 SF
	WALKS = 16204 SF
	POND = 11254 SF
	MISC = 622 SF
	LOT AREA = 288752 SF (6.63 AC)
	PERVIOUS = 134062 SF (3.08 AC)
	GREENSPACE = 46.4%

V3 Companies
7325 Janes Avenue
Woodridge, IL 60517
630.724.9200 phone
630.724.9202 fax
www.v3co.com

Visio, Vertere, Virtute... "The Vision to Transform with Excellence"

REVISIONS			
NO.	DATE	DESCRIPTION	

PROJECT NO.: 8530.REST	DESIGNED BY: PHG
FILE NAME: Prop Lot Coverage	DRAWN BY: DB
ORIGINAL ISSUE DATE: 01-19-09	CHECKED BY: RK
SCALE: 1" = 30'	PROJECT MANAGER: RK

VICTORIAN VILLAGE

HOMER GLEN ILLINOIS

PROPOSED LOT COVERAGE EXHIBIT A

DRAWING NO. **2/3**

8530.REST - PROPOSED LOT COVERAGE EXHIBIT